

The Future Of Line Marking

Product Brochure



1L of Our Paint

Covers an estimated

5 million

blades of grass.

We use nothing but the finest materials including:

TiO₂

(titanium dioxide)



Stacking all the line marking paint drums we supply annually would reach a height of

21km

This equates to 2.3 times the height of

Mount Everest



We supply
1 million
kilograms of line marking paint annually

Equalling the weight of

150

adult elephants

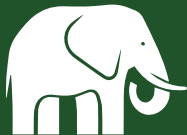

Our products are supplied to over

80%

of European countries

We supply to an estimated
20,000
pitches
worldwide

The World's Best

play on pitches marked by Pitchmark



We have supplied

5 major

football tournaments in the last 10 years

Index

About Us	3
Line Marking Paint	4
Eco-Friendly Packaging	16
Line Marking Machines	18
Accessories & Spares	30
LineFix	32
Handbook	33
Where To Buy	34
Contact Us	35

About Us

Founded in 2010, Pitchmark is a King’s Award-winning family business based in Bristol, UK, with a vision of raising the standard of line marking and to improve the quality of working life for ground staff globally.

Our mission is simple: to provide the best and most user-friendly products on the market at competitive prices. Supplying products is backed up by our customer-focused approach to service and support. All these factors are fast making us the number one choice in line marking internationally.

Our clients include some of the world’s best grounds staff, whose work is seen by millions of people every week. As well as leading grounds staff, our products are also used by grounds staff at grassroots sport level.

We are proud to play a small yet important part in UEFA Euro 2020™, FIFA World Cup 2022™, Champions League™, English Premier League™ and more.





Line Marking Paint

We supply a complete range of specialist line marking paints for any customer and any sport.

Our advanced technology paints are carefully developed, thoroughly tested and all are water-based and eco-friendly with a very low level of VOCs (Volatile Organic Compounds).

Our paint is manufactured from the highest quality pigments and binders available, enabling us to offer the most consistently bright and weather-resistant products in the marketplace.

READY-TO-USE No mixing required, shake well and it's ready to go. _____



●

●

●

●

ECOLINE+

Quality: ★★★★★
Price: £££ page 6



●

DIRECT

Quality: ★★★★★
Price: ££ page 7



●

TRANSFER+

Quality: ★★★
Price: £ page 8

CONCENTRATE Designed to be mixed thoroughly with water. _____



●

EXTREME

Quality: ★★★★★
Price: £££ page 9



●

LUMEN

Quality: ★★★★★
Price: ££ page 10



●

●

●

●

CLUBLINE

Quality: ★★★
Price: £ page 11

SPECIALIST Innovative coatings for your surface including artificial and robot. _____



●

●

●

●

●

AGP (ARTIFICIAL)

Quality: ★★★★★
Price: £££ page 12



●

EDGE (ROBOT)

Quality: ★★★★★
Price: ££ page 13



○

LINE-OUT

Quality: ★★★★★
Price: £££ page 14

ECOLINE+

Ready-To-Use

Quality: ★★★★★ Price: £ £ £

Highest quality, low-consumption line marking paint for spray markers. Dries quickly allowing you to water your pitch soon after marking yet maintain a crisp, durable line with no ghosting.

We consider **Ecoline+** the most advanced line marking paint. Many examples can be seen every week in the English Premier League™, meeting the highest standards possible.



Surface:
Natural Grass

Machine:
Spray

Paint Type:
Ready-to-Use

Size:
10L

Maximum pitches per 10L:

5

Colours:



For Over Marking
Pitchmark 2 S/S Nozzle



For Initial Marking
Pitchmark 3 S/S Nozzle



Maximum number of
pitches per 10L container

DIRECT

Ready-To-Use

Quality: ★★★★★ Price: £ £

High quality, advanced technology, low-consumption ready-to-use line marking paint for spray markers. Dries quickly to give a very durable and bright line. Mark a football pitch with as little as 2.5 litres using low-volume nozzles.

Direct is very similar to our **Ecoline+** but requires slightly more paint per pitch at a cheaper price, whilst still maintaining high-end results.



Surface:
Natural Grass

Machine:
Spray

Paint Type:
Ready-to-Use

Size:
10L

Maximum pitches per 10L:



4

Colours:



For Over Marking
Pitchmark 4 S/S Nozzle



For Initial Marking
Pitchmark 6 S/S Nozzle



Maximum number of
pitches per 10L container

TRANSFER+

Ready-To-Use

Quality: ★★ ★ Price: £

A bright and long-lasting ready-to-use paint specially formulated with added thickeners for wheel-to-wheel markers like our **Classic**. Great quality product that can be diluted at 1-1 if required.

Ready to pour into the machine before marking, it is the perfect paint for clubs with wheel-to-wheel marker and limited time.



Surface:
Natural Grass

Machine:
Transfer Wheel

Paint Type:
Ready-to-Use

Size:
12L

Maximum pitches per 12L:
 **2**

Colours:

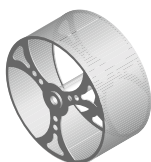
For use with a Transfer
Wheel Machine



Maximum number of
pitches per 12L container

EXTREME

Concentrate

Quality: ★★★★★ Price: £ £ £

Our highest quality concentrate line marking paint. **Extremely** bright and fantastic durability make this the perfect choice for turf professionals and for use under the floodlights.

Extreme is a particularly versatile paint as it is designed to be used through any spray or wheel-to-wheel marker.



**Super Concentrate**

**Low Carbon Footprint**

**Stadia**

**12 M**

**2
HDPE**

**25°C
10°C**

**16.5
KG**

Surface:
Natural Grass

Machine:
Spray & Transfer

Paint Type:
Concentrate

Size:
10L

Maximum pitches per 10L:
 **6**

Colours:

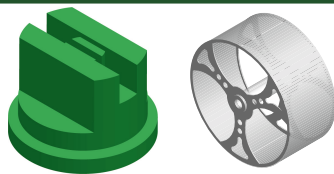
Use with Green F/F
Nozzle or Transfer Wheel

Water
5L



Paint
1.5L

Recommended Mixing Ratio for **1**
Full-Size (11v11) Football Pitch

LUMEN

Concentrate

Quality: ★★★★★

Price: £ £

Our mid-level concentrate paint, offering brighter results than **Clubline**, but at a lower price per drum than **Extreme**. Perfect for amateur and professional users alike.

Lumen comes in standard 10L plastic containers and is also available in Pitchmark's innovative, eco-friendly bag-in-box packaging. Additionally, it can be supplied in 600L and 750L IBCs, which are highly convenient for grounds maintenance contractors and councils when marking multiple pitches.



Surface:
Natural Grass

Machine:
Spray & Transfer

Paint Type:
Concentrate

Size:
**10L, 600L, 750L,
10L bag-in-box**

Maximum pitches per 10L:
 **5**

Colours:



Use with Green F/F
Nozzle or Transfer Wheel

Water
4.5L



Paint
2L

Recommended Mixing Ratio for 1
Full-Size (11v11) Football Pitch

CLUBLINE

Concentrate

Quality: ★★ ★ Price: £

Offers excellent adhesion to the grass, giving you a very bright line with good coverage. This is the perfect concentrate paint for weekly marking and is very cost effective.

Clubline is also available in blue, red & yellow. Blue paint is perfect when marking junior football pitches inside full-size adult pitches, and is recommended by the FA.



Surface:
Natural Grass

Machine:
Spray & Transfer

Paint Type:
Concentrate

Size:
10L, 600L, 750L

Maximum pitches per 10L:
 **4**

Colours:

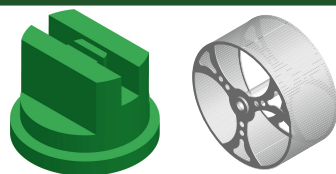
Use with Green F/F
Nozzle or Transfer Wheel

Water
4L



Paint
2.5L

Recommended Mixing Ratio for 1
Full-Size (11v11) Football Pitch

AGP

Ready-To-Use

Quality: ★★★★★ Price: £ £ £

AGP (Artificial Grass Paint) is an advanced ready-to-use formulation designed for artificial grass surfaces including 3G and 4G. Using the latest acrylic binders provides greater adhesion to the surface making it long-lasting and durable.

AGP is available in white, black, red, yellow or blue, perfect for marking multiple sports on one surface.



Surface:
Artificial & Hard Surfaces

Machine:
Spray

Paint Type:
Ready-to-Use

Size:
10L

Maximum pitches per 10L:
 **1**

Colours:



For use with Green F/F
Nozzle



Maximum number of
pitches per 10L container

EDGE

Ready-To-Use

Quality: ★★★★★ Price: £ £

Introducing **Edge**, Pitchmark's latest specialist formulation, designed for use with any spray or robot line marking machine.

Edge is supplied in Pitchmark's innovative, eco-friendly bag-in-box packaging, and is compatible with standard hollow cone nozzles.



**Save Water**

**Fast Drying**

**Robot Friendly**

**12 M**

**BOX RECYCLABLE**

**25°C
10°C**

**13 KG**

Surface:
Natural Grass

Machine:
Spray & Robot

Paint Type:
Ready-to-Use

Size:
10L bag-in-box

Maximum pitches per 10L:
 **4**

Colours:



For Over Marking
Pitchmark 4 S/S Nozzle



For Initial Marking
Pitchmark 6 S/S Nozzle



Maximum number of
pitches per 10L container

LINE-OUT

Concentrate

Quality: ★★★★★ Price: £ £ £

Line-Out is a specialised green concentrate paint designed to cover white lines.

Line-Out is ideal for stadia with multi-sport pitches, catering to all levels from grassroots to elite. It can be diluted to achieve the desired shade and is suitable for use with both spray and transfer wheel markers.



Surface:
Natural Grass

Machine:
Spray

Paint Type:
Concentrate

Size:
10L

Colours:
○

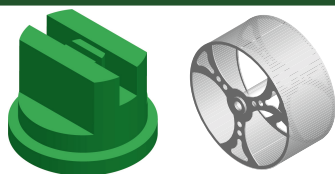

Use with Green F/F
Nozzle or Transfer Wheel

Water
4L



Paint
2L

Can be further diluted to achieve
the desired shade of green

BULK CONTAINERS

IBC Line Marking Paint

We supply **Clubline** & **Lumen** in 600 & 750 litre IBC's (intermediate bulk container), which grounds maintenance contractors and councils find very useful when marking out multiple pitches.



Clubline

Paint
600L



Football Pitches
240



Paint
750L



Football Pitches
300



Lumen

Paint
600L



Football Pitches
300



Paint
750L



Football Pitches
375



BAG-IN-BOX

A sustainable solution

Pitchmark has taken a significant step towards sustainability with the launch of our new environmentally friendly **Bag-in-Box** packaging.

This innovation represents a major milestone in our commitment to reducing plastic waste and lowering carbon emissions, starting right at the Bag-in-Box's source.

One truck can carry 5,280 drums, which equates to 24 pallets, whereas **6,000 empty bags** would only occupy **2 pallets**.



90% reduction in packaging and plastic waste



89% fewer CO2 emissions created during production



500g saving compared to using a plastic jerry can container

ECO PACKAGING

A sustainable solution



As the name suggests, the paint is stored in a durable, eco-conscious bag housed within a recyclable cardboard box. This simple yet efficient design offers a far more sustainable alternative to the plastic drums that have long been the industry standard.

These improvements don't just benefit the environment – they also bring tangible advantages for you. With significantly less plastic to dispose of, you will see **reductions** in both **waste** and **removal fees**.



75% reduction in CO2 emissions from transportation in supply chain, compared to rigid containers



75% less shipping space required in supply chain, compared to rigid containers



100% recyclable outer cardboard packaging



Line Marking Machines

We manufacture a range of line marking machines including wheel-to-wheel, and spray line markers.

Our line marking machines are hand-built in Bristol to the highest specification and from the best materials available, guaranteeing strength and durability.

What makes our machines so unique is that they are designed by grounds staff, for grounds staff, ensuring they are the most user-friendly machines on the market.



HYBRID page 20



ECO CLUB page 22



ECO PRO page 24



FUSION page 26



ECO LITE page 27



CLASSIC page 28

*25-litre paint tank sold separately**

HYBRID

3-Wheel Spray Marker



Our **Hybrid** is the premium line marking machine designed with and for sports turf professionals, perfect for use on stadium pitches.

The **Hybrid** combines the manoeuvrability of a three-wheeled marker with the efficiency of a spray marker.

Advanced patent-pending technology on the highly-engineered front wheel, combined with the proven spray system from the **Eco Club** and **Eco Pro**, give perfect results on the pitch.



Unique front wheel gives the machine great precision & manoeuvrability for lifting over lines.



Advanced pump system with 3-stage filtration gives consistent quality lines and fewer blockages.



Solid, puncture-proof wheels offer consistently smooth operation for any grass surface.



The **Hybrid** at The Stoop in Twickenham, England



Battery allows marking of up to 12 full-size football pitches, with external socket for recharging.



Manufactured by hand at Pitchmark headquarters in Bristol, UK.



Optional 25-litre paint tank available.

ECO CLUB

Spray Marker

An easy-to-use spray line marking machine, offering customers versatility and affordable quality.

Designed by grounds staff, for grounds staff, straightforward to use and easy to maintain for all users. To make the job even quicker and easier, try our ready-to-use **Ecoline+** and **Direct** paints and save time by cutting out the need to mix paint.



The Eco Club chassis can hold 1 x 10L paint drum or bag-in-box.



High-pressure pump offers improved run-time and removes the need for an in-line filter.



Strong tubular spaceframe chassis with easily-adjustable 50mm to 150mm (approx. 2" to 6") line width.



The **Eco Club** at Le Parc des Princes in France



Battery allows marking of up to 8 full-size football pitches, with external socket for recharging.



Simple switch to turn the machine on and off quickly and easily.



This machine can be upgraded with drop-in tanks & higher power batteries. See **Eco Pro** page 24.

ECO PRO

Spray Marker

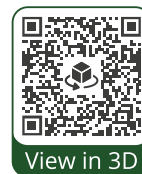

The **Eco Pro** is a high-end upgraded version of our popular **Eco Club** spray marker, and is just as easy to use for all grounds staff.

Using the same proven chassis and components to achieve a fantastic line, the **Eco Pro** significantly benefits from extras including a 6L water tank for cleaning, an upgraded 3-stage filtration pump system for improved performance, and a larger battery for extended use.



The Eco Pro includes one 6L Water Tank as standard

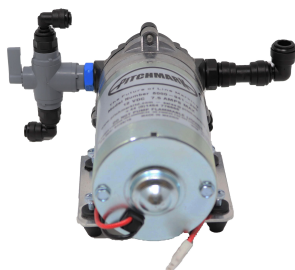

Advanced pump system with 3-stage filtration gives consistent quality lines and fewer blockages.



Strong tubular spaceframe chassis with easily-adjustable 50mm to 150mm (approx. 2" to 6") line width.



The **Eco Pro** at SGS College in Bristol, England (25-litre paint tank sold separately)



Battery allows marking of up to 12 full-size football pitches, with external socket for recharging.

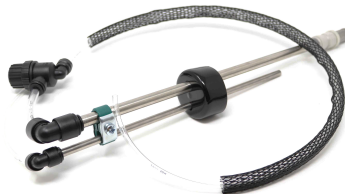

Accessibility to all parts allowing easy maintenance.



Optional 25-litre paint tank available.

FUSION

Spray Marker

Affordability, performance, and appearance make the **Fusion** an excellent choice for all line marking needs. Combining both the style and engineering from its older sibling, the **Hybrid**, along with a high-density polyethylene (HDPE) body instead of a steel chassis.

Our **Fusion** also boasts advanced patent-pending technology on the highly-engineered front wheel, combined with the proven spray system from the **Eco** range, giving perfect results on the pitch time after time.



View in 3D



High-density polyethylene (HDPE) body with adjustable front end and handlebars.



High-pressure pump offers improved run-time and prevents blockages.

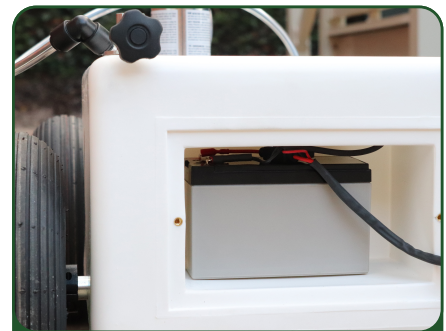

Battery allows marking of up to 8 full-size football pitches, with external charging & switch cable port.

ECO LITE

Spray Marker

The **Eco Lite** is designed by grounds staff, for grounds staff, so is straightforward to use and easy to maintain for all users.

The plastic chassis is a real game changer, reducing costs dramatically, whilst maintaining the sturdiness that's synonymous with the Pitchmark brand. During testing, grounds staff were surprised with just how robust & sturdy the machine felt in-hand.



View in 3D



Convenient slot in the body for an aerosol can.



Optional drop-in 25L paint tank.



Body can hold 1 x 10L paint drum or bag-in-box.

Classic

Transfer Wheel Marker



The **Classic** is extremely easy-to-use and popular with amateur and professional grounds staff alike, including several stadia. The **Classic** is available in 50, 75, 100, and 120mm line width variants with an 18L paint capacity.

This machine is made to a demanding specification from the best quality materials available.



Very strong powder-coated steel frame with adjustable handlebar height.



Solid puncture-proof wheels offer consistently smooth operation.

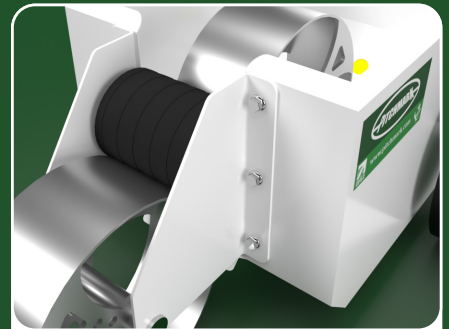

Unique polyroller combined with precise transfer wheels gives a great line, every time.



The **Classic** at the Johan Cruyff Arena in Amsterdam, Netherlands



Camp des Loges - France



Estadio La Cartuja - Sevilla



London Stadium - UK



Accessories & Spares

We supply a complete range of accessories and equipment to help with marking your sports pitch.

Listed on the right are some of our most popular & fundamental accessories for marking pitches, but more can be found on our website.

If you want your pitch to look smart & professional, our field accessories will suit you down to the ground.

We also stock a full range of spare parts for our machines, making it easy for you to fix and service them yourself.



Aerosol Spray Cans 750ml

Pitchmark's Promarker aerosol cans are perfect for a wide range of hard surfaces, artificial grass and spot marking on natural grass.



100m Measuring Tape

This sturdy 100 metre (330ft) measuring tape is perfect for grounds staff when setting out pitches for the initial mark, helping you create the most accurate pitch possible.



200m String Line

A specialist string designed & developed for line marking. Specifically designed not to stretch, allowing you to have perfect straight lines!



Pitch Marking Pegs

For stringing out and marking sports pitches on grass. These pegs have a screw thread to make it easier to use when the ground is hard, particularly in the summer months.



Professional Marking Kit

The Professional Marking Kit from Pitchmark is the perfect complete pre-season kit to enable groundsmen to measure and string out pitches from scratch.



Spare Parts

We supply all required spare parts & replacements for our range of line marking machines. These can be purchased through your nearest distributor.

LINEFIX

Socket System

LineFix is a unique, innovative system specially developed for the re-marking of sports pitches.

LineFix is perfect for line marking on winter sports pitches like rugby and football, as well as for cricket wickets. **LineFix** is also suitable for pitch mowing bands amongst other uses.

Installed by screwing into the ground just below the surface, the sockets remain in place all season, allowing you to string out completely accurately week after week.

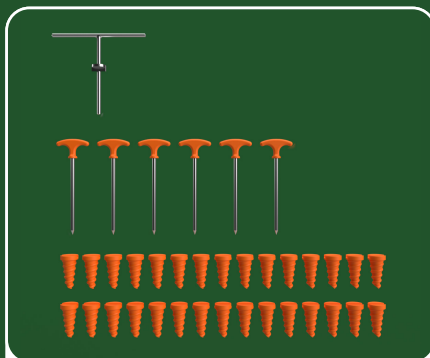

LineFix Starter Kit: 30 sockets, 6 pins, key, and carry bag.



Save time by not having to measure your pitch every season – leave sockets in the ground.



LineFix Mowing Pins can be used to repeatedly string accurate mowing bands, time after time.

LINE MARKING

Handbook

Our aim at Pitchmark is to help make life easier for ground staff worldwide, especially when it comes to line marking, so we've produced some advice and a number of diagrams to help with the process of line marking.

This handy pocket-size booklet will speed up your line marking, cut time and most importantly; cut costs, by allowing you to mark more pitches and minimise the time spent finding pitch dimensions.



Concise 8-step how-to mark a pitch guide.



Contains 22 pitch, court and track dimensions to aid you when out initial marking.



WHERE TO BUY

Pichmark Products



United Kingdom

You can order online through our exclusive UK distributor, Turfix, at:

www.turfix.co.uk

SCAN HERE



Worldwide

Find your nearest dealer & distributor here:

www.pitchmark.com/global

SCAN HERE



Contact Us

Customer service is very important for us here at Pitchmark and we'd love to hear from you. You can find all of our contact details on our website.



Website

www.pitchmark.com



X (Twitter)

@pitchmarkLtd

Socials

You can find us posting frequent updates, discount codes and offers on our social media. Drop us a follow and tag us in any pictures of your pitch or line marking and we'll feature you on our page!



Instagram

@pitchmark_linemarking



Facebook

@linemarking

Our App

The free Pitchmark app is perfect for anyone in the sports turf industry and for all things line marking! Download for free and access a wide range of features including sports pitch dimensions, exclusive offers and 'How To' guides for line marking.



App Store

Pitchmark



Play Store

Pitchmark



The Future of Line Marking



Part of The
Pitchmark Group

